

# Kit 1360

SKODA Octavia II, 5-dr Hatchback, 04-

480R  
754

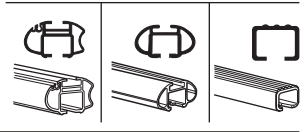
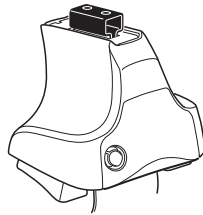

480

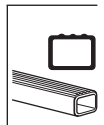
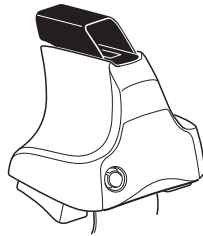

750

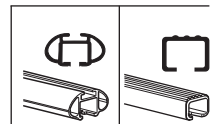
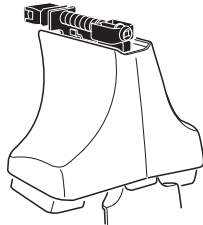

**Max. 75kg**  
**Max. 165 lbs**

x1

x1

x1

x4

x4

x4

x4

x4

x4

x4

x4

x4

x4

x4

x2 x2 x2 x4	x2	x2 x2 x4 x4	x2 x2	x2

← **661** x1

← **662** x1

← **668** x1

← **673** x1

← **179** x2

← **181** x2

x1

**Kit**

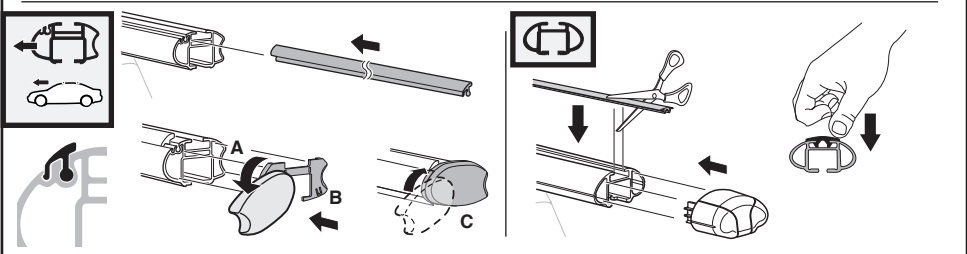

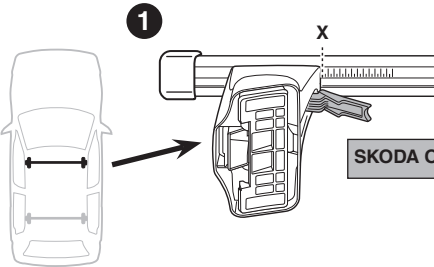
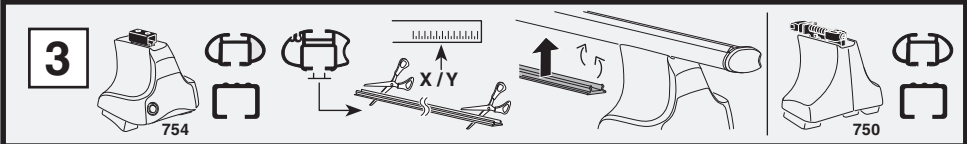

	X
SKODA Octavia II, 5-dr Hatchback, 04-	33

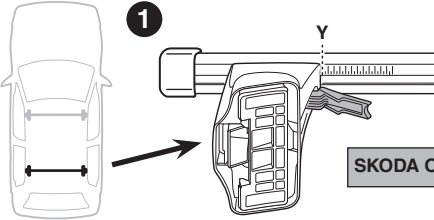

	Y
SKODA Octavia II, 5-dr Hatchback, 04-	30

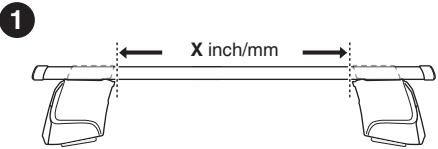
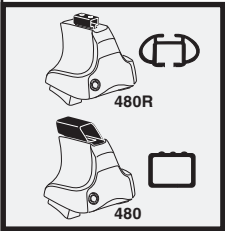

	X inch	X mm
SKODA Octavia II, 5-dr Hatchback, 04-	38 5/8"	981 mm

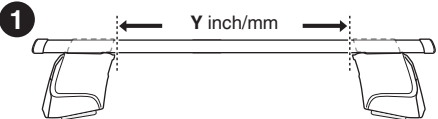
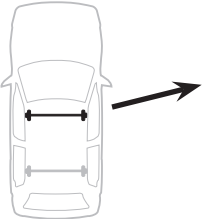

	Y inch	Y mm
SKODA Octavia II, 5-dr Hatchback, 04-	37 1/2"	951 mm

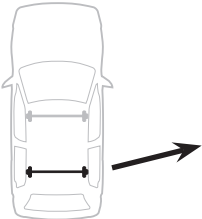

4

SKODA Octavia II, 5-dr Hatchback, 04-

179



661



181



673

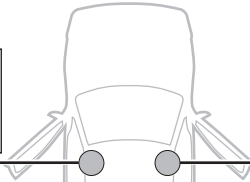

181



662



179



668

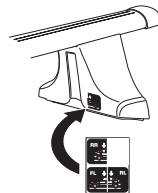
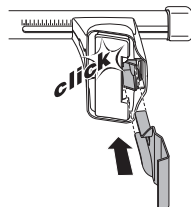
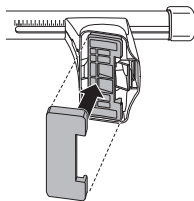
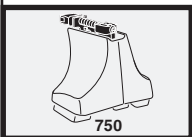
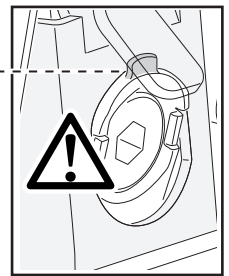
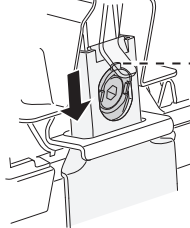
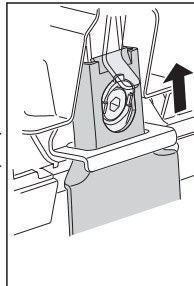
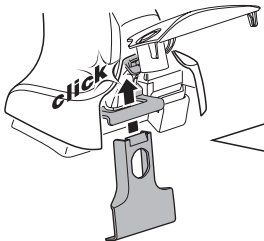
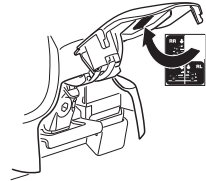
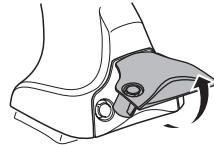
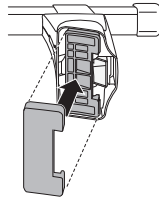
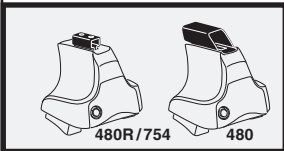

5

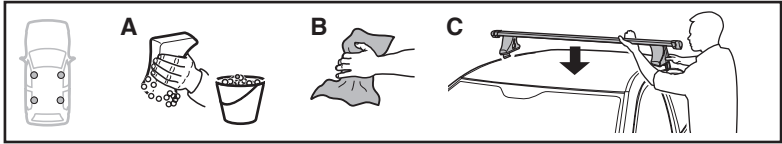

	X mm	Y mm	X inch	Y inch
SKODA Octavia II, 5-dr Hatchback, 04–	235 mm	820 mm	9 1/4"	32 1/4"

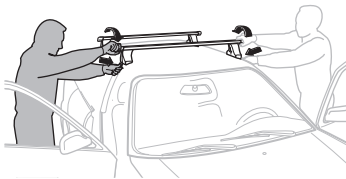
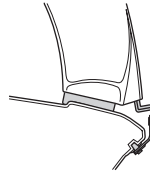
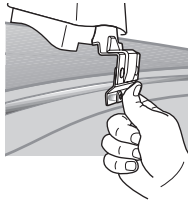
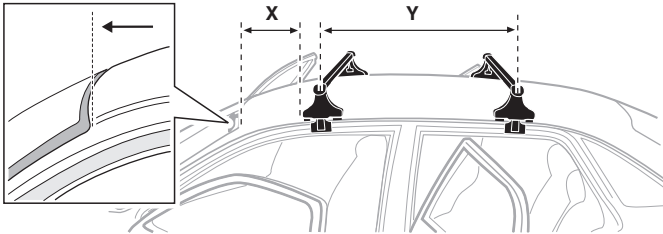

**GB/US** Tighten alternately

**D** Die Schrauben abwechselnd anziehen

**F** Serrer alternativement chaque côté

**NL** Afwisselend aan de linker- en de rechterkant aandraaien

**I** Alternare il serraggio delle viti

**E** Apertar alternativamente

**PT** Aperte alternadamente

**S** Dra åt växelvis

**FIN** Kierrä vuorotellen

**EST** Pinguldage vaheldumisi

**LAT** Pielieciet pamišus

**LIT** Užsukinėkite pakaitomis

**PL** Śruby dokręcaj naprzemiennie

**RU** Затягивайте попеременно

**CZ** Pokręťta bagażníka dokręcaj dokręcaj naprzemiennie.

**SK** Doťahujte striedavo

**SLO** Privijajte izmenično.

**HR** Naizmjenično zategnite

**HU** Egymástól függetlenül szorítandó

**GR** Σφιγγετε εναλλάξ

**TR** Dönüşümlü sıkın

**中文** 交替拧紧

**한국어** 번갈아 가며 조이십시오.

**日本語** 交互に締め付けてください。

**ไทย** ชันโนแบบสลับ

6



480R/754



480

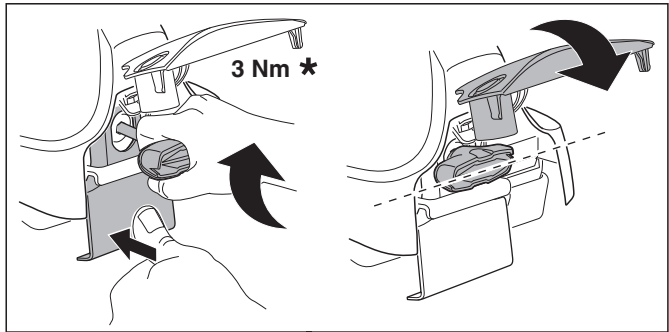
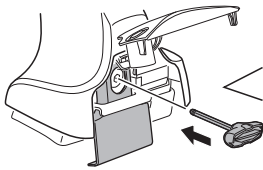

3 Nm \*

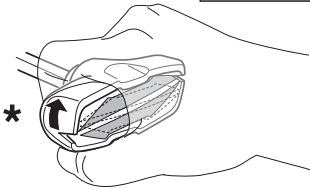

\*

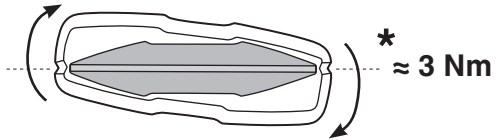

\* ≈ 3 Nm



750

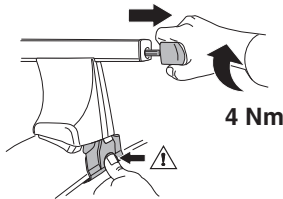

4 Nm

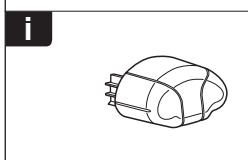
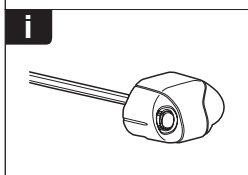
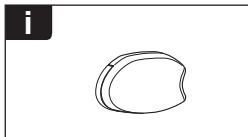
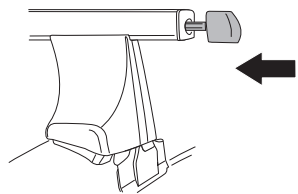

1

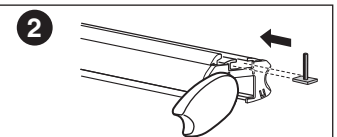

2

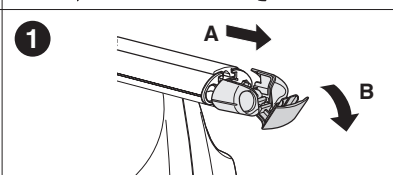

1

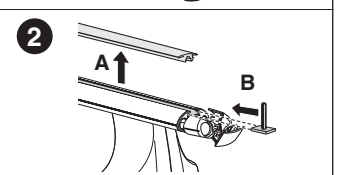

2

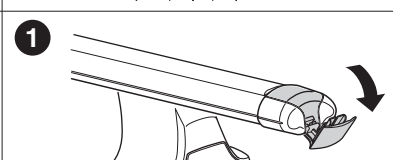

1

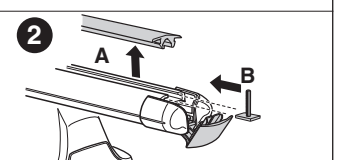

2

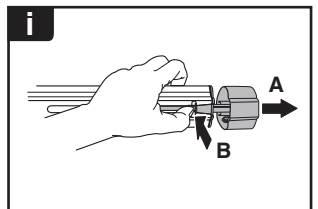
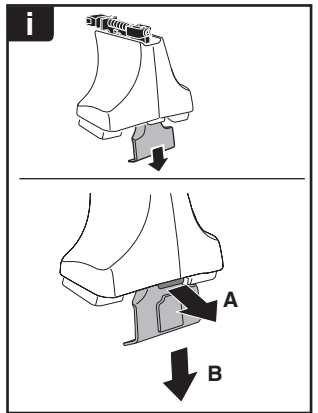
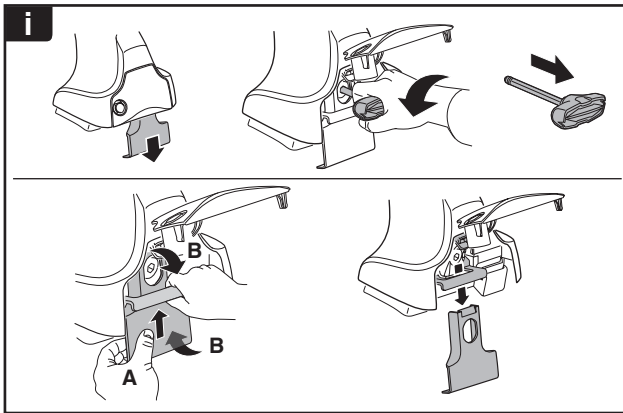
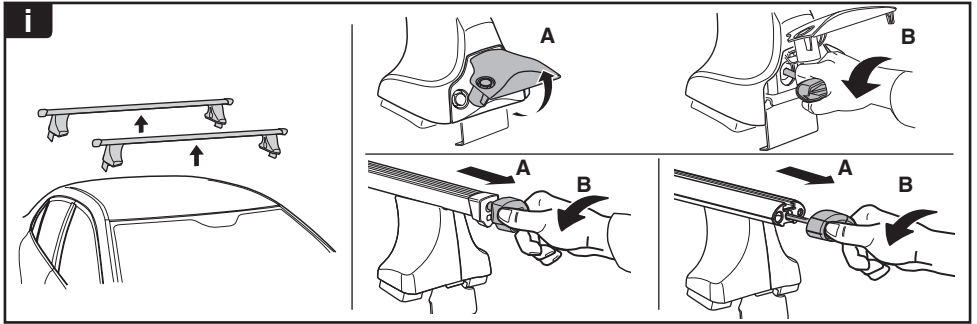

**THULE**  
SWEDEN  
**ONE  
KEY  
SYSTEM**

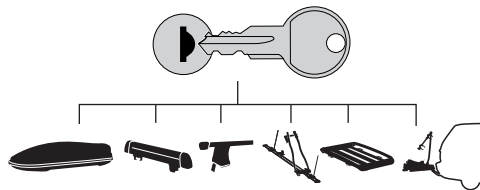

		(x4)
		(x6)
		(x8)
NA		(x10)
EUR		(x12)
ASIA		(x12)



WW ▶ Thule Sweden AB, Box 69, 330 33 Hillerstorp, SWEDEN  
NA ▶ Thule Inc., 42 Silvermine Road, Seymour, Connecticut 06483, USA

info@thule.com  
customer.service@thule.com

www.thule.com